

PX2-530 - 555W

182mm 144Cells MBB PV Solar Module

21.48%

MAXIMUM EFFICIENCY

0.55%

YEARLY DEGRADATION

PERC HALF CUT CELL

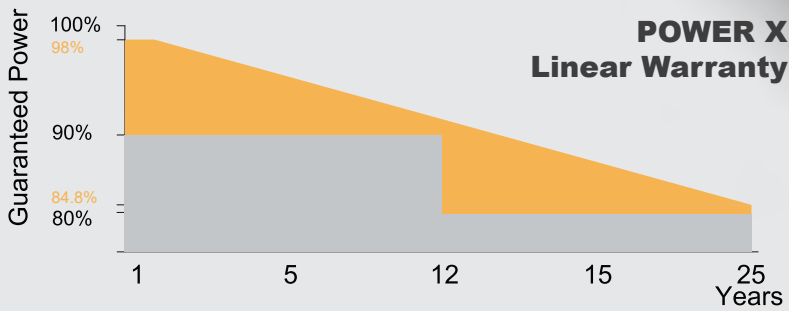

12 Years
Material & Craft
Quality assurance

12 Years
90% Output
Power guarantee

25 Years
80% Output
Power guarantee



Excellent Low-light Performance



100% Inspection Guarantee Reliability



10BB technology reduce the distance between busbars and finger grid line which is benefit to power increase



High Density Packaging



Strengthened Mechanical Load

POWER X



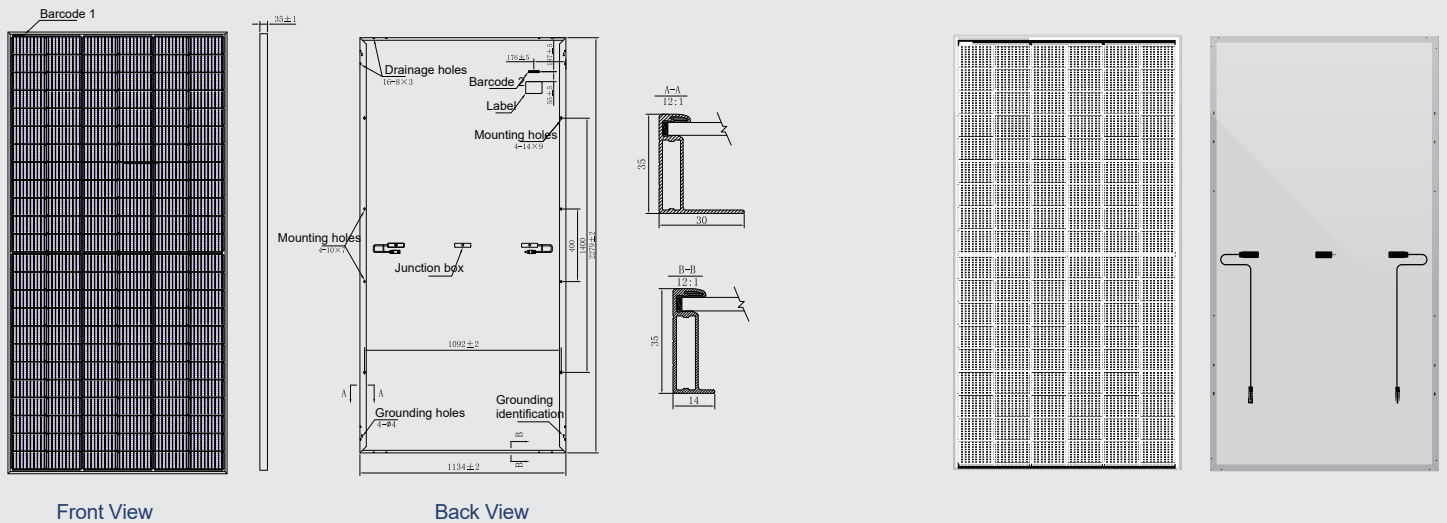

*Remark: customized frame color and cable length available upon request

Electrical Characteristics (STC/NOCT)

Module Type	PX2-530		PX2-535		PX2-540		PX2-545		PX2-550		PX2-555	
	STC	NOCT	STC	NOCT	STC	NOCT	STC	NOCT	STC	NOCT	STC	NOCT
Maximum Power- Pmax(W)	530	396.30	535	400.00	540	403.50	545	407.20	550	410.80	555	414.70
Open Circuit Voltage - Voc(V)	49.30	46.10	49.50	46.20	49.70	46.40	49.90	46.60	50.10	46.80	50.30	47.00
Short- Circuit Current - Isc(A)	13.66	11.03	13.72	11.08	13.78	11.13	13.84	11.18	13.90	11.22	13.96	11.27
Voltage at Pmax -Vmp(V)	41.00	38.20	41.20	38.30	41.40	38.50	41.60	38.70	41.80	38.90	42.00	39.00
Current at Pmax - Imp(A)	12.94	10.39	13.00	10.43	13.05	10.48	13.11	10.52	13.16	10.57	13.22	10.62
Module Efficiency -ηm(%)	20.51 /		20.70 /		20.89 /		21.09 /		21.28 /		21.48 /	
Power Tolerance(W)	(0, +4.99W)											
Maximum System Voltage(V)	1500Vdc (IEC / UL)											
Maximum Series Fuse Rating (A)	25A											

STC : Irradiance 1000W/m², Module Temperature 25±2 °C, AM 1.5 NOCT : Irradiance 800W/m², Ambient Temperature 20 °C, AM 1.5, Wind Speed 1m/s

Mechanical Specifications

External Dimensions	2279×1134×35 mm (With Frame)
Weight	28±1kg
Solar Cells	Mono crystalline 182mm (6×24)
Front Glass	3.2mm, High Transmission, AR Coated Tempered Glass
Frame	Anodized aluminum alloy
Junction Box	IP68, 3 diodes
Output Cables	4 mm ² , 350 mm (With Connectors)
Connector	MC4 Compatible
Mechanical Load	Front Side Max. 5400Pa, Rear Side Max. 2400Pa

Packing Configuration

	2279×1134×35 mm (With Frame)
Container	40'HQ
Pieces per Pallet	31
Pallets per Container	20
Pieces per Container	620

Temperature Characteristics

Pmax Temperature Coefficient	-0.35%/ °C
Voc Temperature Coefficient	-0.29%/ °C
Isc Temperature Coefficient	+0.05%/ °C
Operating Temperature	-40 °C ~ +85 °C
Nominal Operating Cell Temperature(NOCT)	44 °C ±2 °C

I-V CURVES OF PV MODULE(530W)

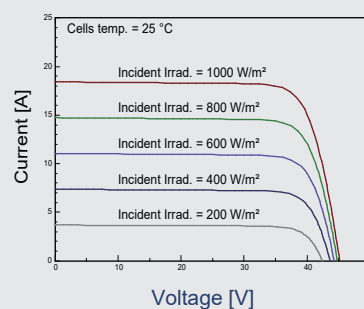

P-V CURVES OF PV MODULE(530W)

